

RCP / RCPD

Clamp Halves

TUBE FITTING PART #	GROUP #	A Metric Tube Size	A Inch Pipe Size	A Inch Tube Size	B (mm)	C (mm)	D (mm)	E (mm)	F (mm)	STANDARD FROM STOCK
RCP108X		8		5/16						•
RCP110X		10								•
RCP112X		12								•
RCP113.5X	1	13.5	1/4							•
RCP114X		14			55	32	33	16	30	•
RCP115X		15								•
RCP116X		16		5/8						•
RCP117.2X		17.2	3/8							•
RCP118X		18								•
RCP220X		20								•
RCP221.3X		21.3	1/2							•
RCP222X		22								•
RCP223X	2	23			70	48	45	24	30	•
RCP225X		25		1						•
RCP226.9X		26.9	3/4							•
RCP228X		28								•
RCP330X		30								•
RCP332X		32		1 1/4						•
RCP333.7X		33.7	1							•
RCP335X	3	35			85	60	60	30	30	•
RCP338X		38		1 1/2						•
RCP340X		40								•
RCP342X		42	1 1/4							•
RCP438X		38		1 1/2						•
RCP440X		40								•
RCP442X		42	1 1/4							•
RCP445X		45								•
RCP448.3X		48.3	1 1/2							•
RCP450X	4	50			115	90	90	45	45	•
RCP451X		51		2						•
RCP452X		52								•
RCP455X		55								•
RCP457X		57		2 1/4						•
RCP460.3X		60.3	2							•
RCP463X		63		2 1/2						•
RCP465X		65								•
RCP470X		70								•
RCP570X		70								•
RCP576.1X		76.1	2 1/2	3						•
RCP580X	5	80			152	120	122	60	60	•
RCP582.5X		82.5		3 1/4						•
RCP588.9X		88.9	3	3 1/2						•
RCP690X		90								•
RCP6101.6X		101.6		4						•
RCP6108X	6	108		4 1/4	205	170	168	85	80	•
RCP6114.3X		114.3		4 1/2						•
RCP6127X		127		5						•
RCP7127X		127		5						•
RCP7133X		133		5 1/4						•
RCP7140X		140	5	5 1/2						•
RCP7152.4X	7	152.4	5 1/2	6	250	200	205	100	90	•
RCP7159X		159		6 1/4						•
RCP7165.1X		165.1	6	6 1/2						•
RCP7168.3X		168.3		6 5/8						•
RCP8168.3X		168.3		6 5/8						•
RCP8177.8X	8	177.8		7	320	270	265	135	120	•
RCP8193.7X		193.7		7 5/8						•
RCP8219.1X		219.1	8	8 5/8						•

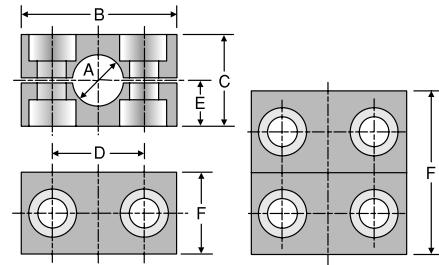

RCP

RCPD

Material codes for clamp halves:

- Polypropylene - RCP
- inside plain - RCPG (for hose)
- Polyamide 6 - RCN
- inside plain - RCNG (for hose)
- Aluminum - RCA



Dimensions and pressures for reference only, subject to change.